

GEMINI Kick-Off Meeting

Date: January 23rd-24th 2024

Venue: De Costerzaal, Amsterdam UMC, location
AMC, Amsterdam



Program

January 23rd

Time		Presenter
9:00	Registration - Sign-in - Refreshments -	
9:30	Welcome - Introductions - Overall Perspective - Detailed Project Vision	Henk/Alfons
10:15	Icebreakers: Each institution, 5 mins max (strictly controlled...) - Conversational introductions - (5-mins max, 3 PowerPoint slides; (1) Institutional background, (2) expertise and highlights, (3) role, people, (please send by January 20 th)	ALL
10:45	<i>Coffee break</i>	
11:15	Icebreakers continuation	ALL
12:30	EDITH Building the European Virtual Human Twin (30', 15'Q&A)	Liesbet Geris
13:15	<i>Lunch</i>	
14:15	WP goals and plans 30 mins per WP (short summary of tasks, planning, deliverables, comment on vision of collaboration with other WPs) <i>WP2-7 (so, keeping to 30 minutes, it's 3 hours, keeping Management out)</i>	
15:30	<i>Coffee break</i>	
15:45	WP goals and plans- continuation	

17.30 Closure

19.00 Drinks and Dinner

Cafe Restaurant "In de Waag"

Nieuwmarkt 4

1012 CR Amsterdam



January 24th

Time		Presenter
8:30	GA meeting- one delegate per partner <i>(advisory board, supervisory board? meeting schedule (when and where), ..)</i>	
9:15	WP1 Things to discuss: <ul style="list-style-type: none"> - Communication <i>(monthly (inter?)WP meetings- also travel budget available)- meetings/flash report etc</i> - Data Storage <i>(RDM plan also needs to contain this)- mention this here, but discuss it separately in a dedicated meeting</i> - Website Re Finance; our financial controller can not make it, so <i>people can sign up to organize a separate dedicated online meeting for questions, or contact him directly.</i>	Laurian/Henk
10:00	<i>Get to know the consortium: blind dates.</i>	10-15'per group, 3 groups
10:45	<i>Coffee break</i>	
11:00	<ul style="list-style-type: none"> - Evolution of acute ischemic stroke treatment - SWOT analysis of mevo - IA and aSAH management: state of the art and limitations <i>30' (10+10+10) lecture, 15'Q&A</i>	Charles Majoie, Bart Emmer, Philippe Bijlenga
11:45	<i>Maybe split up in people working on ischemic strokes and hemorrhagic strokes and discuss how the first year will look like, and how that feeds back to the WPs or WP2-4 and WP 6-7 sit together?</i>	
13.00	<i>Lunch (also a separate WP leader lunch for tips&tricks)</i>	
14:00-15:00	Wrapping up, room available for continued discussions after 15:00 (L0-219)	Charles/Alfons

Public transport in the Netherlands:

The trains are run by the NS (“Nederlandse Spoorwegen”) and the local public transport by GVB (metro, tram) or Connexion (most busses). We have an ‘OV card’ that works on all public transport by checking in and out through the turnstiles (train and metro) or machines (in the bus). Regardless of whether you have a paper ticket or a plastic card you’ll need to check out to get out of metro and train stations.

- When you are just here for the consortium meeting it’s probably easiest to take the NS trains and get one-off paper tickets from the yellow vending machines. Careful check your selection at Schiphol as they sometimes pre-select 1st class tickets on the machines.
- You can buy a multiple day ticket valid for both NS and local transport (within Amsterdam only) which might be worth it if you are planning on staying in Amsterdam for more than the consortium days and want to see some sights: <https://www.ns.nl/producten/en/overige-kaartjes/p/amsterdam-travel-ticket>
- It is also possible to buy hour or day tickets for local metro/tram/bus transport at the machines at the bigger stations, if you are looking for a small side trip.
- You can get an ‘OV card’ at <https://www.ov-chipkaart.nl/everything-about-travelling.htm>. Make sure to ask about activation for the NS trains when you buy it. However, it will cost 5 euros to get a card and need to charge it with a minimum amount to be able to use it on the train. We only suggest to do this when you’re planning multiple trips to the Netherlands.

For more information:

- NS train services (journey planner): <https://www.ns.nl/en>
- Public transport planner: <https://9292.nl/en>
- Google Maps also works well for journey planning

How to get from Schiphol Airport to the AMC?

Address: Meibergdreef 9, 1105 AZ, Amsterdam Zuidoost

- Buy a one-way NS train ticket at one of the yellow vending machines at Schiphol Airport. Select ‘Amsterdam Holendrecht’ as your destination.
- The trains to Holendrecht run a few times an hour. You’ll have to change trains at ‘Amsterdam Bijlmer Arena’. Depending on the connection the journey will take you 20-30 minutes. Use one of the above-named websites to schedule your journey.
- The metro lines 50 and 54 will also stop at Amsterdam Holendrecht.
- At the station (‘Amsterdam Holendrecht’ – red circle on the map) make sure to take the ‘AMC Meibergdreef’ exit (blue signs above the platform). Check out at the turnstiles and you’ll see a walkway to your right. Follow that to the AMC.

Within the AMC:

Whether you come with train or subway you arrive at the same station (Amsterdam Holendrecht). Walk towards the AMC (follow the red line, which is the main walkway) and you get to the main entrance of the AMC.

After entering, follow the red arrow, walk straight towards the first square (Het centrale plein, “the main square”) and turn right. The meeting room (Costerzaal) can be found on your right hand side (the red square on the map). If you reach the next square (Voetenplein, “the feet square”, because it’s surrounded by posters of feet) you have gone too far.;-)

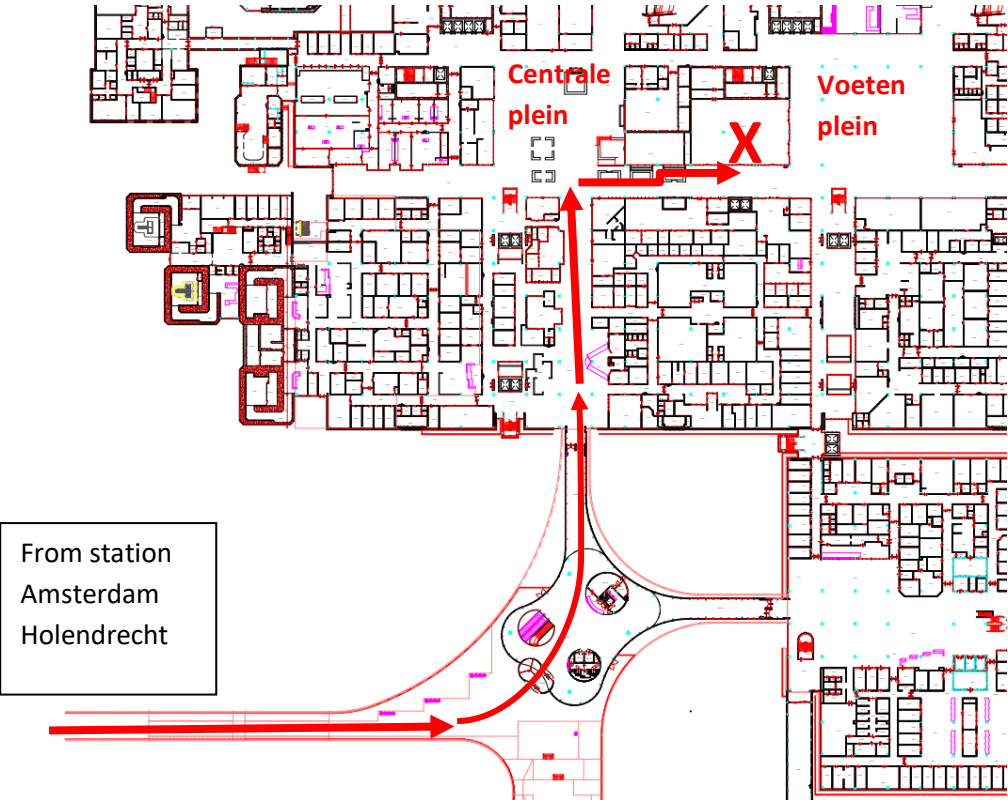

Route Hotels to AMC:

I have found two hotels quite close to the meeting venue (Amsterdam UMC) which you can/could book depending on your preference (little price difference). Top left is OZO Hotel, close by the joy hotel and at the bottom you see the AmsterdamUMC. The blue dots is the walking distance (~30 minutes), however, you can also take the metro (top right you see the metro station Bullenwijk (8 minute walk), one stop, get out at Amsterdam Holendrecht (bottom right) and from there it's 5 minutes to the AMC, see above for more info and the walking route). Hotel info can be found under this map.

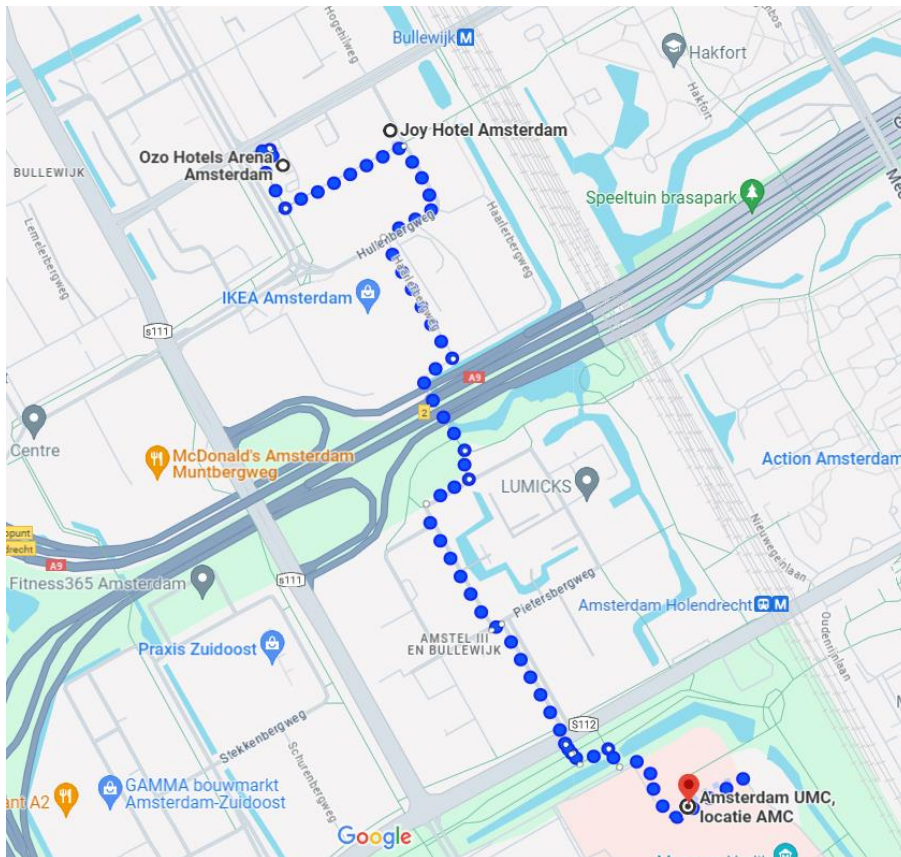

Joy Hotel

Hullenbergweg 385
1101CS Amsterdam, The Netherlands
Tel.: +31-(0)20-737-1503
www.joyhotel.nl

OZO Hotels Arena Amsterdam

0031 (20) 220 2500
Karspeldreef 2, 1101 CJ Amsterdam
<https://www.ozo-hotels.com/nl/hotels/ozo-hotels-arena-amsterdam>

When you are lost or in doubt call Laurian: +31628686990.